

# The Brooklyn Schools

119 Gorman Road  
Brooklyn, CT 06234  
Phone: (860) 774-9732  
Fax: (860) 774-6938

Patricia L. Buell  
Superintendent  
[buell@brooklynschools.org](mailto:buell@brooklynschools.org)

August 26, 2019

Dear Parents,

Our current traffic pattern needs to change due to the traffic stopping on Louise Berry Drive. We can no longer permit cars to park there to wait to pick up in the preschool circle. We have adjusted our BES drop off and pick up to eliminate parking on Louise Berry Drive effective immediately. We will be outside to assist you with this new traffic pattern. Please see the map below and the explanation of where you should drive to drop off and exit the school parking lots.

We will no longer be using the preschool circle for drop off and pick up. Only employees will be allowed to enter the parking lot behind the preschool building from Louise Berry Drive to park for the day. No parents will be allowed to enter this area as this will be a one way, **EXIT ONLY ONTO Louise Berry Drive**.

Parents dropping off or picking up at the elementary school will enter the north parking lot near the Brooklyn Middle School gym and follow the road all the way behind both buildings and drop off or pick up behind the preschool building and at the end of the grades 3 and 4 wing. We would like to load and unload as many cars as possible in this area. Please watch for staff members who will direct you to pull all the way up. Children should get out of the LEFT SIDE OF YOUR CAR to avoid getting out on the parking lot side.

The far west side of the parking lot will have middle school parents and staff exiting onto Louise Berry Drive. Please be aware that you will need to merge to exit the parking lot.

Parents of middle school students should stay to the right as they are traveling behind the schools. You will be able to exit from that lane onto Louise Berry Drive.

Please note: we will monitor this pattern and anticipate one more change to facilitate parents exiting from the BMS parking lot. We hope to add lines to the parking lots to assist with this. Until that time, **WE ASK THAT ALL TRAFFIC ENTER BY THE BMS PARKING LOT AND EXIT ONTO Louise Berry Drive**.

Thank you to the many people who have provided input into making the traffic pattern functional and safe for our students and staff. As always, I am open to your feedback! Have a wonderful and safe school year!

Sincerely,

*Patricia L. Buell*

*Superintendent*

# The Brooklyn Schools

Only BES drop off and pick up in back.

West

BMS drop off and pick up no change.

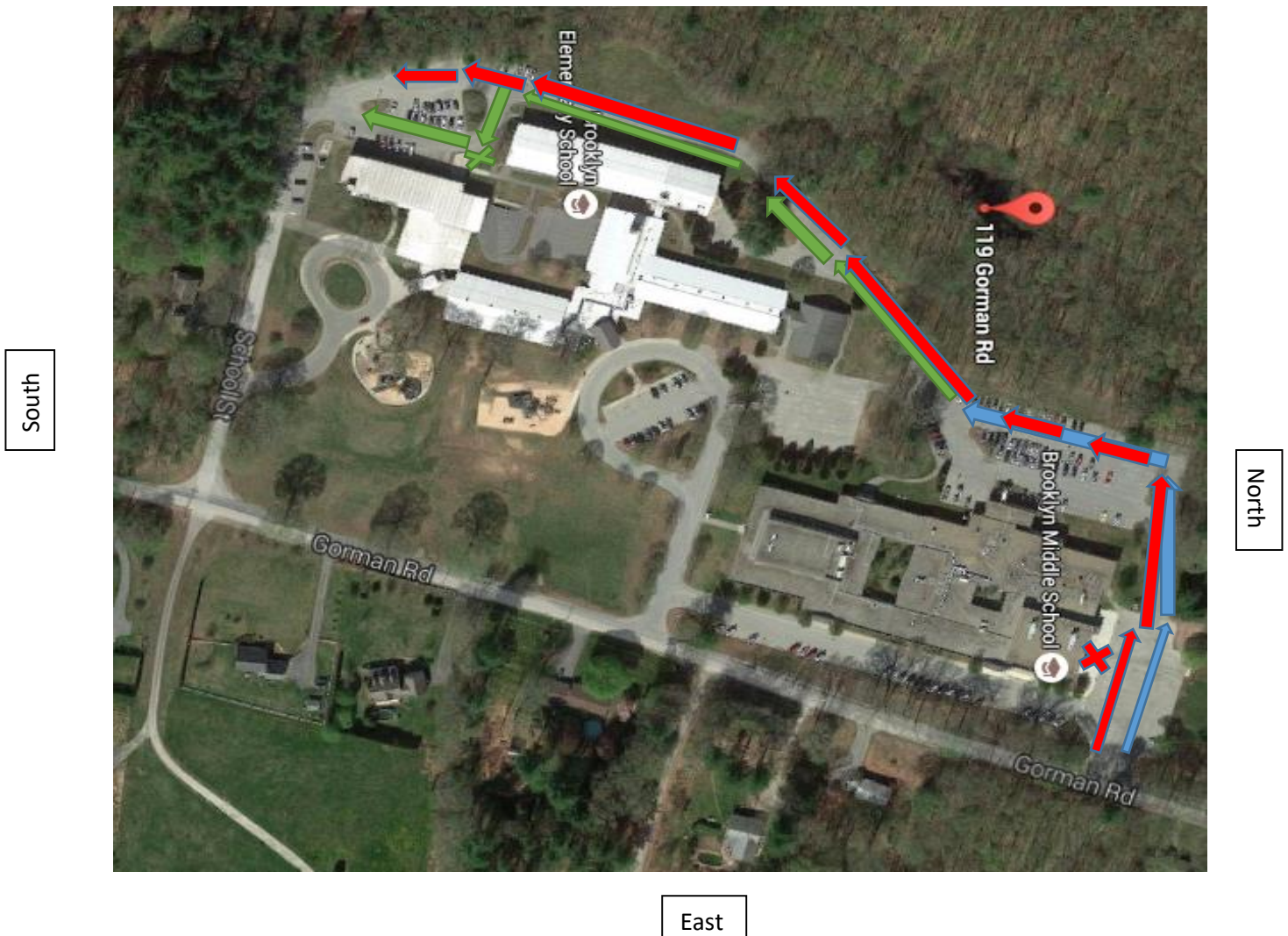

All parent drop off and pick up enter following the blue lines: north side near the BMS gymnasium. BES parents follow the blue lines until you turn behind BES. STAY TO THE LEFT AND FOLLOW THE GREEN LINE! You will pick up and drop off behind the preschool area. ❌

Middle School drop off and pick up as you did last year, along the curb near the gym. ❌ THIS WILL CHANGE. turn left.

Elementary School drop off and pick up. Follow the blue line into the middle school parking lot near the gym, north side. Follow the blue lines, then follow the green lines. At the parking lot west of the preschool, turn left to drop students off at the ❌. Exit the parking lot onto Louise Berry Drive.